

Section-AA
Scale 1:20

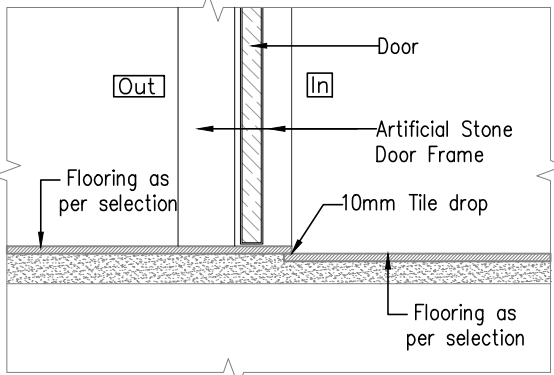

Detail_A
Scale 1:10

Legend for Flooring

(A)		Vitrified Tile (1200x600)
(B)		Vitrified Tile (600x600)
(C)		Granite Stone

Matt Finish Vitrified Tile

Legends for hatch

	Proposed Wall Masonry
	Proposed RCC Structure

R1	07-06-25	SC & PR	GMDC	Tender	KBP
R0	08-03-25	SC & PR	GMDC	Tender	KBP
Rev	Date	Issued	Issued to	Issued for	Author

Key Plan:

Project: SKVM

Drawing: Flooring Layout_GF
Hostel Building
Sheet 01 OF 02

Drawing Code: 2331_ARC_TD_15_R1

Print Size: A3 Scale: 1:100

File Title: 2331_ARC_TD_15_R1

Project Code: MSA 2331	Project Type: ARC & INT	Location: Mandvi
Print Date: 7-Jun-25	Drawn By: K Patel	Checked By: K Patel
		Approved By: M Shah

MAMTA SHAH & ASSOCIATES
Architects & Interior Designers
C-12, Chanakyapuri Society,
Chanakyapuri Char Rasta,
New Sarna Road, Baroda
Ph. No. +91 965 2715267 / 2710967
mamta@msain.com / www.msain.com

Client: Gujarat Mineral Development Corporation